

REVISIONS		
NO.	DESCRIPTION	DATE

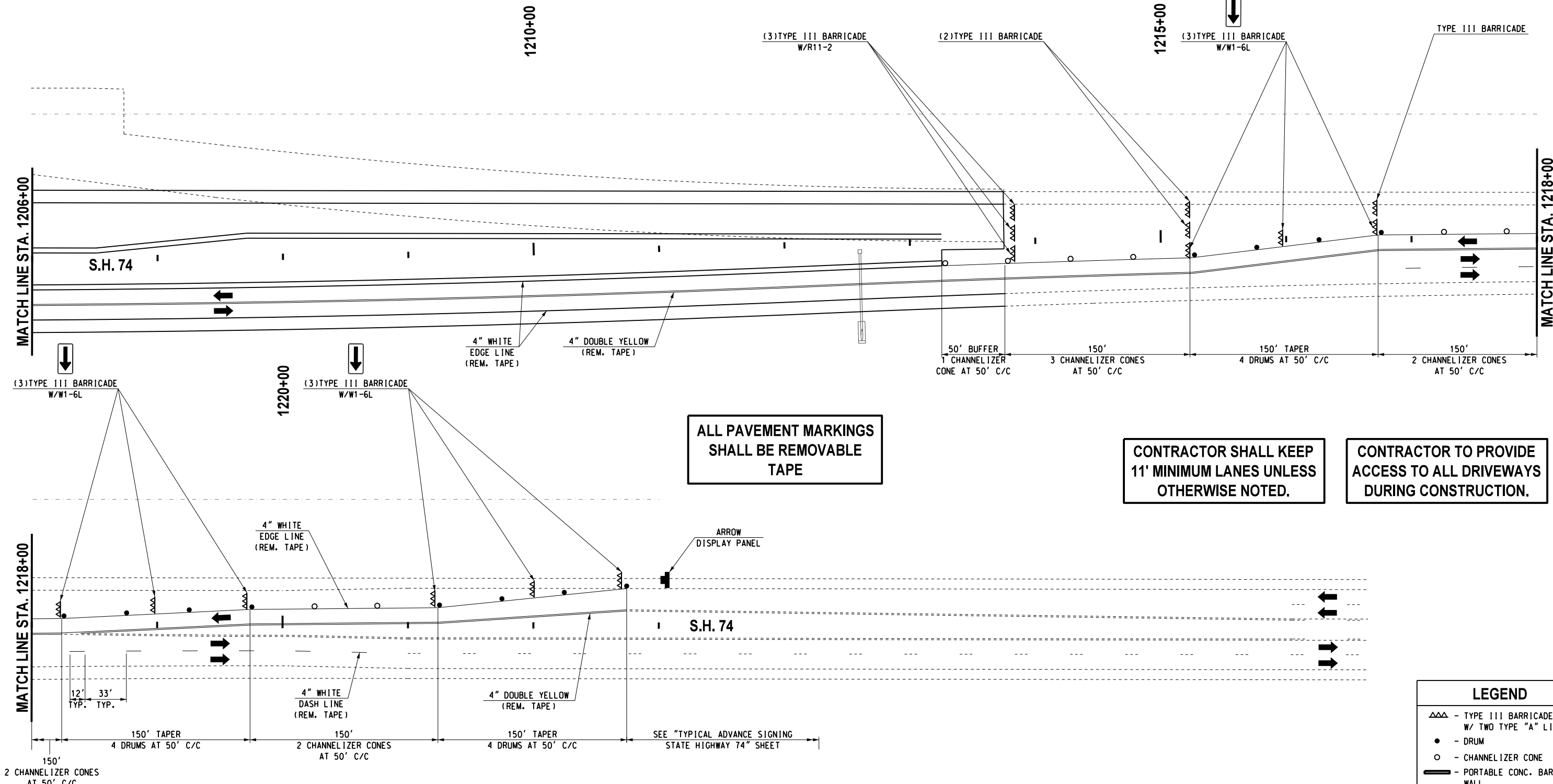
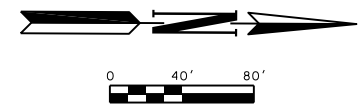

**ALL PAVEMENT MARKINGS  
SHALL BE REMOVABLE  
TAPE**

**CONTRACTOR SHALL KEEP  
11' MINIMUM LANES UNLESS  
OTHERWISE NOTED.**

**CONTRACTOR TO PROVIDE  
ACCESS TO ALL DRIVEWAYS  
DURING CONSTRUCTION.**

LEGEND	
	- TYPE III BARRICADE W/ TWO TYPE "A" LIGHTS
	- DRUM
	- CHANNELIZER CONE
	- PORTABLE CONC. BARRIER WALL
	- CONSTRUCTION ZONE IMPACT ATTENUATOR
	- WORK AREA

Design	RWR	08/10/17
Drawn	GDB	08/10/17



**TRAFFIC CONTROL  
PHASES 3U,4A & B (SHEET 9 OF 9)  
S.H. 74 (STA. 1206+00 TO 1223+00)**  
State Job No. 14964(08) Sheet No. 193

08/10/17 G:\Projects\T-1662B SH 74 @ NW 178th, NW 192nd & NW 206th\CAD\TC PHASE 3U,4A,B,9 SH 74.dgn